

YOUR DONEGAL FAMILY

A GUIDE TO GENEALOGY SOURCES



CULTURE DIVISION, DONEGAL COUNTY COUNCIL



Donegal County Museum Collection

DRYING PEATS



Comhairle Contae
Dhún na nGall
Donegal County Council

The information contained in this publication was correct at the time of going to print.
May 2020

Genealogy is the study of one's ancestors or family history and is one of the most popular hobbies in the world. Genealogy makes history come alive because when people learn about their ancestors, they are able to make connections to historical events. Family History is the biographical research into your ancestors. The aim is typically to produce a well-documented narrative history, of interest to family members and perhaps future generations. It involves putting flesh on the skeleton of what is produced by genealogy and involves the study of the historical circumstances and geographical situation in which ancestors lived.

As custodians of the collective memory of County Donegal, genealogy/ family history resources are an important Culture Division service. This booklet was produced by the Library, Archives and Museum Services of the Culture Division, Donegal County Council to provide a brief introduction to resources available within these services and to other resources and agencies that can help to guide researchers in tracing their Donegal family tree.

While Donegal County Library, Donegal County Archives and the Donegal County Museum are happy to provide guidance and assistance, they are not genealogical institutions and in general they cannot conduct detailed research for individuals.



Beginning your Research

To begin, try to establish as accurately and completely as possible the basic genealogical facts of as many of your near relatives as you can:

- names (forenames and related family names)
- places of residence (the parish or townland in which they lived, see: www.townlands.ie/donegal/) A townland is the smallest territorial division within each county and can range in size between one and several thousand acres. They have been used extensively in land surveys, censuses and polling systems since the 17th century and are the basis for rural postal addresses
- approximate date and place of birth/baptism
- date and place of marriage
- date and place of death/burial.



Rutherford Family Collection
Caroline Carr

It is best to work backwards

from known information about already-identified ancestors. Trying to work forwards rarely works.

Talk to your immediate family and ask questions of those you think might know a little bit more about your family history. Check to find what documents (certificates, letters, newspaper cuttings, family bibles, photograph albums, diaries, etc.) you or they possess. This information will point the way to relevant records. Religious denomination is also important in determining which records are relevant to your research.

Researching your Irish ancestry is limited by the fact that many census records, family genealogies and Church of Ireland parish registers were destroyed when the National Archive in the Four Courts in Dublin was burnt in 1922. However Roman Catholic parish registers mainly survive, though few date back beyond the end of the 18th century and are not available for all parishes. There are various other records, but it is difficult to trace an Irish line further back than the early 17th century, unless through Clan records etc.

There are numerous books and online sources that can assist you to begin your research including:

- Tracing your Irish Ancestors: The Complete Guide /John Grenham, 2019
- Tracing your Donegal Ancestors / Helen Meehan and Godfrey Duffy, 2008
- Tracing Your Irish Family History on the Internet: A Guide for Family Historians / Chris Paton, 2019
- Donegal Genealogy Resources: www.donegalgenealogy.com
- Irish Genealogy: www.irishgenealogy.ie
- Family Search: www.familysearch.org
- Find My Past: www.findmypast.ie
- Ancestry: www.ancestry.com



Gweedore, Late 1880's
Private Collection

Donegal County Library - Central Library, Letterkenny _____



The Central Library is located on Oliver Plunkett Road, Letterkenny, Co Donegal.

Central GPS 54.948382,-7.737889

Contact Central Library on (074) 9124950 or email

central@donegallibrary.ie

More information can be found on website at www.donegallibrary.ie

The Central Library, Letterkenny, houses an extensive collection of books, journals and other materials on

genealogy and family history that can help you get started on your search for that elusive Donegal ancestor.

While the staff is unable to carry out the research, they are happy to provide guidance and assistance.

It is possible to photocopy many of our resources; where there are exceptions these can usually be photographed without a flash. All photocopying must comply with the Copyright and Related Rights Act 2000.

Donegal Studies Section

The Donegal Studies is located in the Central Library, Letterkenny.

The reference collection is available during library opening hours and some items are available for loan.

The catalogue is available online at www.donegallibrary.ie

A member of staff is always present to provide guidance and assistance and to bring the materials to the researcher.

If you feel that you would need to access microfilmed materials it is advisable to book the microreader in advance.



Microfilm Reader, Central Library
Courtesy Caroline Carr

Donegal County Library is in the process of digitising selected items from the Donegal Studies collection and is prioritising items to be digitised to meet the needs of researchers, while aiming to preserve the most delicate and at risk items in their collections. This will allow their collections to become more accessible via web and other formats to users both at home and abroad.

To date, Donegal County Library has digitised the following books which are hosted on www.askaboutireland.ie/reading-room/digital-book-collection/digital-books-by-county/donegal/

- Ballyshannon: Its History and Antiquities / Allingham, Hugh, 1937
- A Copy of Register of Deeds in County Donegal / MacIntyre, A, 1935
- Inishowen/ Maghtochair, 1867
- A History of the Diocese of Raphoe / Maguire, Very Rev. E, 1920
- Letterkenny Past and Present / Maguire, Very Rev. E, 1917
- Statistical Survey of the County of Donegal / McParlan, James, 1802
- The Flight of the Earls / Ó Cianáin, Tadhg, 1916
- The Martyrology of Donegal / O'Donovan, John, 1864
- The Scenery and Antiquities of South-Western Donegal / Stephens, James, 1872



Rare Books

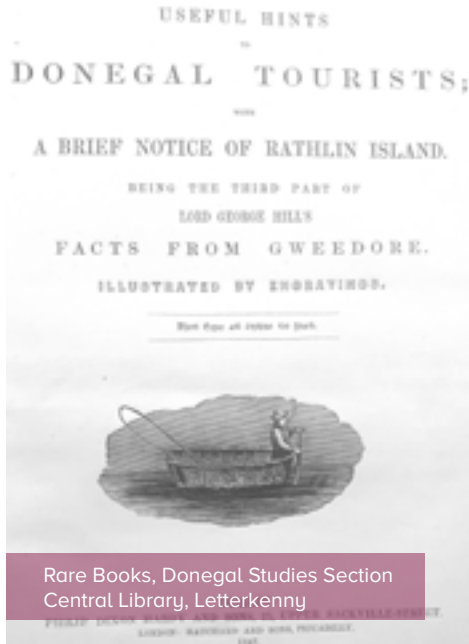

The Central Library holds a collection of old and rare books published about Donegal or by Donegal authors in the eighteenth and nineteenth centuries. The following titles are just a representative sample of this rich treasure trove.

- A History of the Diocese of Raphoe / Rev Canon Edward Maguire, 1920 [2 Volumes]
- A Generation of Montgomerys / Henry Montgomery, Bishop of Tasmania, 1907.
- The Wrays of Donegal, Londonderry and Antrim / Charlotte Violet Trench, 1945.
- Irish Distress and its Remedies: The Land Question: A Visit to Donegal and Connaught in the Spring of 1880 / James H. Tuke, 1880.
- A Tour of Ireland in 1775 with a view of the Salmon-Leap at Ballyshannon / Richard Twiss, 1775.
- Three Hundred Years in Innishowen / Amy Isobel Young, 1929.
- The O Cléirigh Family of Tír Conaill / Father Paul Walsh, 1938.
- A Tour in Ireland with observations on the present state of that Kingdom made in the years 1776, 1777 and 1778 and brought down to the end of 1779 / Arthur Young, 1780.
- Beatha Aodha Ruaidh Uí Dhomhnaill / The Life of Hugh Roe O'Donnell Prince of Tirconnell 1586-1602 / Lughaidh O' Clery, 1893.
- Facts from Gweedore with Useful Hints to Donegal Tourists / Lord George Hill, 1846.
- The Family History of Hart of Donegal / Henry Travers Hart, 1907.
- The Harvey Families of Inishowen, Co. Donegal and Maen Co., Cornwall / Lieut-Col. GH Harvey, 1927.

Unique Sources and Resources to be found at the Central Library include:

- A list of families in the Parish of Conwal 1878 / compiled by W. Craig
- County Donegal Revenue Employees c.1675-c.1786 / compiled by Aidan Manning
- Donegal Soldiers granted Out Pensions, 1783-1822 / compiled by Aidan Manning
- Householders in St. Johnston, 1794
- Land grants in the Precinct of Liffer (Lifford), barony of Raphoe and County of Donegal: 1608 Plantation of Ulster
- List of persons in the parish of Culdaff, March 8th, 1782
- List of Protestant householders in the Parish of Leck in 1766
- Murlog Church baptisms 1773-1777
- Old Letterkenny families / compiled by Sam Fleming
- Protestant householders in the Parish of Templecrone, County Donegal in 1799, with a list of Churchwardens of the same Parish, 1775-1900
- Raphoe Marriage Registers: Some eighteenth century Catholic marriages in the Protestant Registers of the Diocese of Raphoe
- Trees planted in Raphoe 1702 (A list of landholders on lands belonging to the Bishop of Raphoe)
- Register of Deeds in County Donegal – Freeholders 1760 - 1769

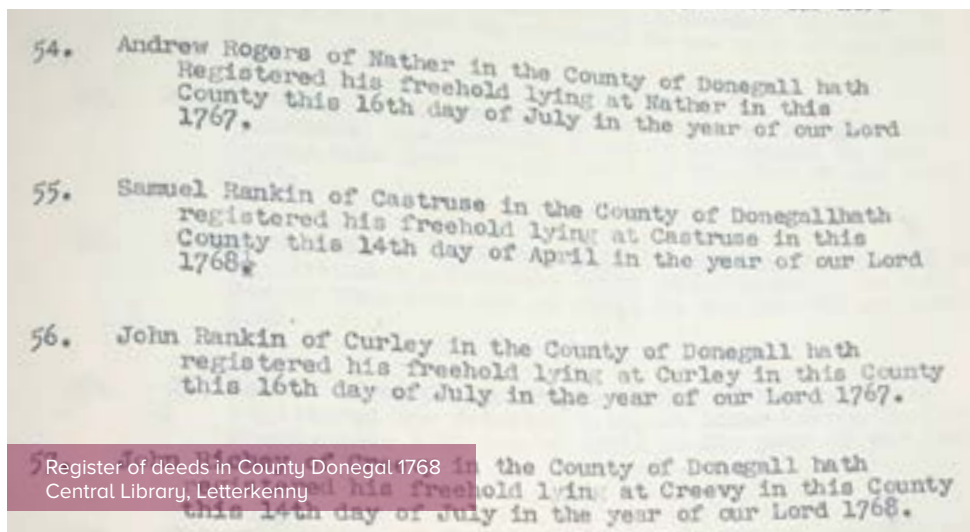

Sources and Resources Available at Central Library

include: _____

LAND RECORDS

Census and Census Substitutes

The Census Returns list all those present in the household on the night of the census, their relationship to the householder, religion, occupation, age and other personal details.

1901 and 1911 Census

Microfilm copies of both the 1901 and 1911 Census for County Donegal.

The 1901 and 1911 Census for the Island of Ireland can be viewed online at www.census.nationalarchives.ie

Other census abstracts include the following: Abstracts from 1841 and 1851 census for County Donegal can be found in British Parliamentary Papers 1851 Census Ireland: Part 1 Ulster and Connacht: Area Population and Housing. This can also be viewed online at www.dippam.ac.uk

[Ireland: 1841/1851 Census Abstracts (Republic of Ireland)/ Josephine Masterson, 1999.

This documents census abstracts from Old Age Pension records.]

Pynnar's Survey 1618-1619

This survey was carried out between 1618 and 1619 and lists the English and Scottish landowners who were granted lands under the Plantation of Ulster. It details the acreage granted to each 'Undertaker', but also surveys the principal Irish tenants remaining on the fortified lands.

[An Historical Account of the Plantation of Ulster at the Commencement of the Seventeenth Century 1608-1620 / George Hill, 1877]

Muster Rolls 1630

Dating from 1630, it is the oldest census substitute held in Central Library. It is a list of the major landowners and of able-bodied men at arms (16-60 years) to be mustered to fight if needed, for the Crown.

The Civil Survey 1654-1656

The Civil Survey is a collation of landowner records based on parish and townland with written descriptions of the boundaries. The value of each townland is given as determined in 1641.

[The Civil Survey A.D. 1654-1656: Counties of Donegal, Londonderry and Tyrone, 1937.]

Pender's Census c. 1659

This Census is also referred to as Petty's or Pender's Census. It provides townland census returns for most of Ireland. The returns supply the name of the principal occupiers of the land, referred to as 'Tituldoes'. It is divided into barony, parish and townland and lists the number of English, Scottish and Irish in each townland. It is a particularly valuable source as it lists the principal Irish names and their frequency, by barony.

[A Census of Ireland circa 1659 / Seamus Pender, 1939]

Hearth Money Rolls 1660s

This is a list of householders liable to pay tax based on the number of hearths (a fireplace) per house, at a rate of two shillings per hearth. It lists the head of the household in each barony and parish liable to pay the tax.

Wills

Wills and testamentary records are an important resource as they provide evidence of the date of death and information relating to family members, place of residence and property.

Central Library holds the following three volumes of Abstracts of Wills at the Registry of Deeds:

[Abstract of Wills at the Registry of Deeds: Vol. 1 (1708-1745)]

[Abstract of Wills at the Registry of Deeds: Vol. 2 (1746-1785)]

[Abstract of Wills at the Registry of Deeds: Vol. 3 (1785-1832)]

Calendars of Wills and Administrations 1858 – 1920 can be searched online at www.willcalendars.nationalarchives.ie

Spinning Wheel Premium Entitlement Lists 1796 (Flax List)

To encourage the linen industry in Ireland the Irish Linen Board awarded free spinning wheels to landholders based on the number of acres of flax planted. Entries are based on parish and the number of spinning wheels awarded to each landholder is listed.

The Tithe Applotment Books 1823 -1838

The Tithe Applotments were compiled between 1823 and 1837 to determine the amount which occupiers of agricultural holdings, over one acre, were liable to pay in tithes to the Church of Ireland. The Tithe Applotment Books are arranged by parish and townland listing the name, the amount of land held and the sum to be paid. Because the tithes were levied on agricultural land, urban areas are not included.

Microfilmed copies are held in Central Library and are available online at www.titheapplotmentbooks.nationalarchives.ie

Register of Deeds in County Donegal: Freeholders 1760 – 1769

A freeholder can be described as a landholder who holds the land forever, but despite the word “free”, the freeholder was almost invariably required to pay rent or render service to a landlord. The Register of Freeholders alphabetically lists the names on the deeds of freeholders in Co. Donegal in the 1760s and 1770s followed by more specific details including the date of registration of the freehold.

Griffith's Primary Valuation 1857-1858

Griffith's Primary Valuation was the first standard valuation of all real property in Ireland and lists householders and lessors by townland, parish, poor law union, and barony. Central Library holds a full set of Valuation books for County Donegal.

Valuation records and maps may be viewed online at www.askaboutireland.ie/griffith-valuation

The image shows a page from Griffith's Primary Valuation for the Parish of Kesh. The table is titled 'VALUATION OF TOWNLANDS' and 'PARISH OF KESH'. It lists various townlands and their details. A pink box highlights the townland 'Kilcar'.

Townland	Name	Acreage	Rate	Valuation	
				1857	1858
...	
Kilcar	
...	

CHURCH RECORDS

Civil registration of births, deaths and marriages did not become compulsory in Ireland until 1864. Therefore Church records are an extremely valuable family history resource. Where these records are stored depends on religious denomination. It should also be noted that a lot of parish records are held locally in parish churches.

Church of Ireland

Church of Ireland Parish Registers for Inver, Mountcharles, Killaghtee and Killybegs are held on microfilm in Central Library.

Permission to print from these records must be obtained from the parish.

Church of Ireland records are held by the Representative Church Body Library:

www.ireland.anglican.org/about/rcb-library/catalogues/parish-records

A small number of Irish parish registers have been digitised and are available to view here and on the Anglican Record Project. This digital record is a work in progress.

www.ireland.anglican.org/about/rcb-library/anglican-record-project

Roman Catholic

Most of the surviving Roman Catholic parish registers prior to 1880 are held on microfilm by the National Library of Ireland. These have now been digitised and can be viewed online at www.registers.nli.ie

More recent records are held locally at the various parish churches.

www.churcharchives.ie/raphoe-diocesan-archives

Methodist

Methodism grew out of the Established Church with people joining the Wesleyan Methodist Society, but remaining in their own churches.

Methodists were expected to go to the parish church for the administration of baptism; therefore it is important to remember to check Church of Ireland records for the eighteenth century. Many Methodist churches in Ulster (including Donegal) have had their records copied by PRONI (Public Record Office of Northern Ireland). These are to be found under reference codes MIC1E and CR6 www.nidirect.gov.uk/publications/proni-guide-church-records

Other records may be held locally or with the Methodist Historical Society of Ireland:

www.methodisthistoryireland.org
Wesley Historical Society:
www.wesleyhistoricalsociety.org.uk/genealogy.html

Presbyterian Church

The Public Record Office of Northern Ireland (PRONI) has microfilmed almost all of the Presbyterian registers in Ireland. A small number of pre-1900 registers and other records are held locally by the Ministers.

www.nidirect.gov.uk/proni

The Presbyterian Historical Society of Ireland also holds some congregational records. These can be found at www.presbyterianhistoryireland.com/collections/library/records

Religious and civil persecution resulting from the Penal Laws meant that many Presbyterian baptisms, marriages and burials were conducted by the Church of Ireland. Therefore it is important to remember to check Church of Ireland records into the eighteenth century. Burial registers for Presbyterian churches are uncommon as there were very few Presbyterian burial grounds.

The Central Library holds hard copy indexes to the following local Presbyterian Churches:

Index to Parish Record	Record	Years Available
First Letterkenny Presbyterian Church	Births and Marriages	1845-1899
Letterkenny Second Presbyterian Church	Baptisms and Marriages	1821-1858
Letterkenny Third Presbyterian Church	Baptisms and Marriages	1841-1899
Gortlee (Letterkenny) Reformed Presbyterian Church	Marriages	1872 -1898
Fannet (Fanad) Presbyterian Church	Births and Marriages	1827-1899

Index to Parish Record	Record	Years Available
Milford Presbyterian Church	Births and Marriages	1838-1899
Rathmullan Presbyterian Church	Births, Deaths and Marriages	1845-1899
Trenta Presbyterian Church Letterkenny	Marriages	1845 -1873 1873 -1938 1958 -1998
	Baptisms	1964 - 1998

Religious Society of Friends (Quakers)

Find My Past holds extensive Quaker records including baptisms, marriages, some deaths, congregational information and school records. The Annual Monitor of the Quakers for Great Britain and Ireland from 1813-1918 also holds obituaries for all Quaker deaths.

www.findmypast.ie/quakers

There are two regional Quaker archives in Ireland:

Dublin Friends Historical Library holds records for Irish Quakers in the Republic of Ireland:

The Religious Society of Friends, Quaker House, Stocking Lane, Rathfarnham, Dublin 6.

Records for Northern Ireland can be found at the following contact:

The Religious Society of Friends, Lisburn Meeting House, 4 Magheralave Road, Lisburn, Co. Antrim.

The National Library of Ireland and PRONI in Belfast have some copies of the Quaker records.

Gravestone Inscriptions

Records of gravestone inscriptions around County Donegal, including a layout plan for the graveyard:

- Aughanishin [Letterkenny]
- Balleeghan [Manorcunningham]
- Ballyshannon Abbey
- St Anne's Church of Ireland, Ballyshannon
- Bruckless
- Carne Graveyard, Pettigo
- Conwal Parish Church and Graveyard [Letterkenny]
- Clonleigh [Lifford]
- Drumholm Graveyard [Ballintra]
- Finner [Bundoran]
- Gartan [Churchill]
- Inver Church of Ireland
- Inver Old Graveyard
- Killaghtee Church of Ireland [Bruckless]
- Killaghtee Old Graveyard [Bruckless]
- Killybegs
- Kilmacrennan
- Kilmonaster [Ballindrait]
- Leck [Letterkenny]
- Magheragallon Old Graveyard [Bloody Foreland]
- Old Glendermott Burial Ground [Derry]

- St Eunan's Cathedral, Raphoe
- Raymoghly [Manorcunningham]
- St Mary's Church of Ireland, Stranolar
- Taughboyne Church of Ireland [St Johnston]
- Templedouglas [Churchill]
- Tullaghobegley [Dunfanaghy]
- Tullyaughnish [Ramelton]

[Donegal Graveyards Part 1-VII / Eileen Hewson, 2008.]

[Remembering the War Dead: British Commonwealth and International War Graves since 1914/ Fergus D'Arcy, 2007.]

More records are available online at the following links:

www.irishgraveyards.ie

www.donegalgenealogy.com



Donegal County Museum Collection



American Liners at Moville
Donegal County Museum Collection

EMIGRATION

Passenger Lists

A number of passenger lists are held (mainly for vessels leaving Derry Port) and US immigration lists:

- Donegal Passengers on the Assisted Passenger List from Plymouth, England to Sydney, Australia (1848-1868), compiled by Richard Reid.
- Emigrants from Derry Port 1847-49 / Dessie Baker (ed.), 1985.
- Immigration of Irish Quakers into Pennsylvania 1682-1750 / Albert Cooke Myers, 1969.
- Irish Passenger Lists 1847-1871: Lists of passengers sailing from Londonderry to America on ships of the J&J Cooke Line and the McCorkell Line, compiled by Brian Mitchell, 1988.
- Emigrants from Ireland to America 1735-1743: A Transcription of the Report of the Irish House of Commons into Enforced Emigration to America / Frances McDonnell, 1992.

Other lists include:

- Assisted immigrants from Donegal arriving in Lyttleton, New Zealand, 1855-1874.
- Passenger list of the “Invercargill”, which sailed to New Zealand 1878 (65 passengers from County Donegal).
- Passenger list of the “Franklin”, Londonderry to Wilmington, Delaware, USA, 1840.
- Passenger list of the “Caribou” arrived Sydney, Australia 4th October 1859.
- The Famine Immigrants, Lists of Irish immigrants arriving at the Port of New York [7 volumes, 1846-1851].
- The Search for Missing Friends: Irish immigrant advertisements placed in the Boston Pilot [8 volumes 1831 – 1920].

Ireland – Australia Transportation

records can be found online:

www.nationalarchives.ie/article/penal-transportation-records-ireland-australia-1788-1868-2/

Information on Orphan Girls who came from the workhouses of Ireland to Australia between 1848 and 1850 can be found at

www.irishfaminememorial.org/orphans/

The Ulster American Folk Park Centre for Migration Studies has a database and genealogical information on emigrants from Ireland (mainly to USA) including passenger lists.

www.qub.ac.uk/cms

Other useful websites include the following:

www.donegalgenealogy.com

www.findmypast.ie

www.ancestry.com

www.irishgenealogy.ie

www.libertyellisfoundation.org

www.familysearch.org

[Across the Atlantic: Emigrating from Moville and Derry / Niamh Brennan and Bernadette Walsh (eds.), 2009.]

TRADE DIRECTORIES

By the 1820's trade directories had begun to cover all of Ireland. Two of the most important are Pigot's Directory and Slater's Directory.

Many of the towns and villages in Donegal are described in detail in both directories. Information includes location, parish, railway stations, churches, constabulary, courts and dispensaries. Trades and businesses are also listed for many locations.

Central Library holds a range of commercial directories, in both printed and microfiche formats.

- Pigot's Directory of Ireland 1820, 1821, 1822 and 1824
- Slater's Directory of Ireland 1846, 1856, 1870, 1881 and 1884
- Porter's Guide to the Manufacturers and Shippers of Ireland / Frank Porter, 1908.



Wool Market, Donegal Town
Donegal County Museum Collection

MILITARY RECORDS

- Royal Irish Constabulary: A Complete Alphabetical List of Officers and Men, 1816-1922 / Jim Herlihy, 2001.
- Royal Irish Constabulary: A Biographical Dictionary and Genealogical Guide, 1816-1922 / Jim Herlihy, 2005.
- Royal Irish Constabulary List and Directory 1919.
- Royal Irish Constabulary Index microfiche.
- County Donegal Book of Honour: The Great War 1914-1918 / Donegal County Museum (5th ed.), 2019.
- Witness Statements 1913-1921 / Bureau of Military History [2 volumes]
- The Liam Ó Duibhir Archive – research materials relating to the War of Independence and the Irish Civil War.

Irish Military Archives

Information on Irish military pension and medal records can be found in the Military Archives, Cathal Brugha Military Barracks, Rathmines, Dublin 6. Their records cover the Easter Rising and the War of Independence, members of Óglaigh na hÉireann, National Army, Irish Republican Army, Irish Volunteers, Irish Citizen Army and Cumann na mBan. <http://www.militaryarchives.ie>

RIC Records

The Police Museum, based in PSNI Headquarters, Brooklyn, 65 Knock Road, Belfast, Northern Ireland BT5 6LE, holds microfilm copies of the Royal Irish Constabulary service records 1822 – 1922, the originals of which are held at the Public Record Office, Kew, London, England. <https://www.psni.police.uk/inside-psni/our-history/police-museum/>

Information on members of An Garda Síochána, the Police Force established after Irish Independence in 1922, can be found at Garda Headquarters, Phoenix Park, Dublin: www.policehistory.com

Dublin Metropolitan Police and Civic Guard (An Garda Síochána) Personnel Registers have been digitised by An Garda Síochána and the UCD Digital Library:

Dublin Metropolitan Police 1837- 1925
An Garda Síochána 1922 -1924
[https://doi.org/10.7925/drs1.
ucdlib_53466](https://doi.org/10.7925/drs1.ucdlib_53466)

The National Archives of Ireland holds a collection of the Wills of Irish soldiers who died while serving in the British

Army. Most date from World War I, but there is a small number from the late 19th Century and from the period of the South African War, 1899-1902:

[www.soldierswills.nationalarchives.ie/
search/sw/home.jsp](http://www.soldierswills.nationalarchives.ie/search/sw/home.jsp)

Useful military websites include:

www.archives.gov
www.bureauofmilitaryhistory.ie
www.decadeofcentenaries.com
www.nationalarchives.gov.uk



LOCAL NEWSPAPER ARCHIVE

Local newspapers are excellent sources of family history as they often list birth, death and marriage details.

Please note: It is advisable to contact the Central Library in advance to book an appointment to view all newspapers.

The following are available on Microfilm:

- The Derry Journal: 1772 – 73, 1825, 1835 – present
- The Donegal Democrat: 1919 – present
- The Ballyshannon Herald: 1831, 1833, 1835 – 36, 1851 – 1883
- The Vindicator: 1906 – 1911, 1921 – 1956
- Donegal People's Press: 1984 – present
- Derry People Donegal News: 1903 – 2010 (missing 1922, 1931, 1942, 1972).
- Inniú: 1943 – 1984

The following are available in hard copy:

- Tirconaill Tribune 1991 – present
- Inish Times 1999 – present
- Inish Independent 2012 – present
- Finn Valley Voice 1994 – present
- The Irish Times: 1969 – 2011

The Irish Times digital archive is available at

[www.donegallibrary.ie/
mainnavigation/onlinelibrary/
research/](http://www.donegallibrary.ie/mainnavigation/onlinelibrary/research/)



Donegal County Library

SCHOOLS FOLKLORE SCHEME 1937-38

In 1937 the Irish Folklore Commission in collaboration with the Department of Education introduced a scheme in which pupils were encouraged to collect and document folklore and local history. The result is a rich collection of local folklore, legends, songs, customs and beliefs, each specific to their own locality. While not every primary school in the country participated, the collection offers a rich source of local traditions. Many people have found pieces written by a family member.

A full list of participating schools in County Donegal is available in Central Library and many be viewed on microfilm.

The collection is also available online at <https://www.duchas.ie/>

[Scéaltai, the 1930s Schools' Manuscript Collection in County Donegal / Eithne Ní Ghallchobhair, 2017]

JOURNALS

Central Library holds a large selection of current and historical journals; many of which contain information on local history useful to the family history researcher.

Below are a few suggested titles:

- Béaloideas 1928 - 2018 (some volumes are missing)
- Clogher Record 1953 – 2012
- Donegal Annual 1947 – present
- Irish Family History 1985 – 2006
- Irish Roots [magazine]
- Ulster Folklife 1959 – 2015 (some volumes are missing)

Journals from the Irish Studies Collection on JSTOR are accessible online in all library branches at www.donegallibrary.ie/mainnavigation/onlinelibrary/research/

LOCAL HISTORY BOOKS

Donegal Library Service aims to collect and preserve all items written by Donegal authors, published in, or about, County Donegal. Family history research is intrinsically linked to local history; therefore this collection offers a valuable source of information and many researchers find that elusive nugget of information that finishes off the tremendous work they have put into tracing their family tree.

The following is just a sample of local history books available in Central Library:

- Ballyshannon Genealogy and History / Anthony Begley, 2011.
- History and Antiquities of Killybegs / Charles Conaghan, 1974.
- Neighbours in Pettigo / Dan Downing, 2018.
- The Tory Islanders: A People of the Celtic Fringe / Robin Fox, 1978.
- Convoy Village: Its People and Townlands / Aodh Gallagher and Marie Stevin, 1996.
- Rambles around the Finn / David Kelly, 1992.
- A Local History of Lifford / Lifford I.C.A., c.1970.
- Mevagh Down the Years / Leslie Lucas, 1962.
- Glencolmcille: A Parish History / Conall Mac Cuinneagáin, 2002.
- An Historical, Environmental and Cultural Atlas of County Donegal / Jim Mac Laughlin and Seán Beattie, 2013.
- A Short History of Gaoth Dobhair / Paul McGeady, 1998.
- History of the Parish of Ardara / P.J. McGill, 1970.
- Cloughaneely Myth and Fact / Gerry McLaughlin, 2002.
- Inver Parish in History / Helen Meehan, 2005.
- Our Town: Letterkenny and Hinterland / Naoi nGiallach, 1998.
- Donegal History and Society / Liam Ronayne et al. (eds.), 1999.
- Where Erne and Drowes Meet the Sea / P. Ó Gallachair, 1961.
- About Raphoe / Raphoe I.C.A., 1998.
- The Book of Inishowen / Harry Percival Swan, 1938.

Donegal County Archives



Donegal County Archives
Photographer: Paul McGuckin

The Donegal County Archives is located in the Three Rivers Centre, Lifford, County Donegal.

Tel: +353 74 9172490

E-mail: archivist@donegalcoco.ie

For more information on sources check: www.donegalcoco.ie/culture/archives

Archives are documents of enduring value that provide evidence of the activities of a person or institution.

They can come in a wide range of formats including written, photographic, moving image, sound, digital and analogue.

The mission of Donegal County Archives is to preserve, acquire and make accessible the documented heritage of the county for the people of County Donegal, for present and future generations.

Donegal County Archives holds a wide variety of archival material useful for academics, local historians, genealogists and family history researchers.

Digitisation

Donegal County Archives, in partnership with Family History website, Find My Past, have digitised and published over 400,000 Donegal Workhouse records. The records consist of both transcripts and images of original admission and discharge registers as well as board of guardians' minute books spanning the years 1840 to 1922.

The collection covers the unions of Ballyshannon, Donegal, Dunfanaghy, Glenties, Inishowen, Letterkenny, Milford and Stranorlar. As well as registers and minute books, there are accounts, death registers, letters, relief registers, supplier contracts and more.

Most features of this website can be accessed without charge at Donegal's libraries and Archives. https://search.findmypast.com/search-ireland-records-in-institutions-and-organisations/and_workhouses-and-poor-law

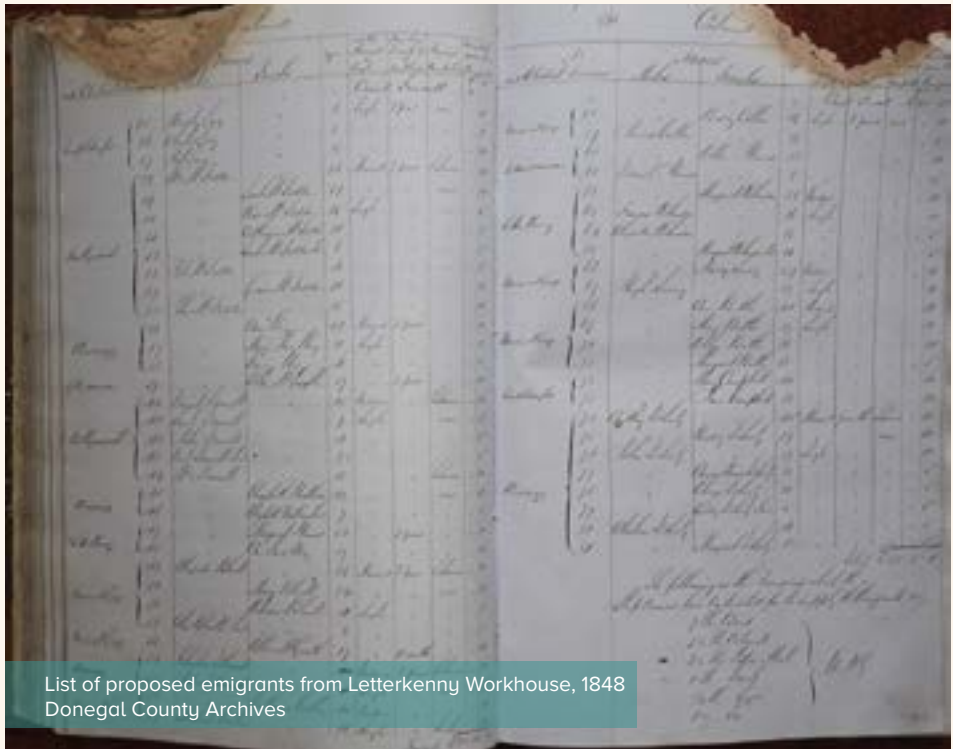

List of proposed emigrants from Letterkenny Workhouse, 1848
Donegal County Archives

Sources and Resources available in Donegal County Archives

Griffith's topographical survey of the parishes of Donegal 1833 – 1859

The 52 handwritten survey booklets in this collection are of properties worth over £5 only. They include descriptions of quantity of land; rate per statute acre; amount (value) of land; and give the number of houses. If there are no houses worth over £5, there is a comment that 'there are no houses in this townland worth £5 a year'.

An overall description of the land includes drainage, relief and soil quality. Other preliminary surveys including field and house books are available to view online at:

<http://census.nationalarchives.ie/search/vob/home.jsp>

General Valuation Registers, c.1917 to 1990

(Note: a few registers date from the 1890s. Survivals and dates vary).

These are the successive registers to the earlier Griffith's Valuation. They contain lists of occupiers and owners of land and property in Donegal and detail how much each household had to pay in rates. They are indexed by electoral area and townland.

There are gaps in this collection. A more complete set is available to view at the Valuation Office in Dublin.

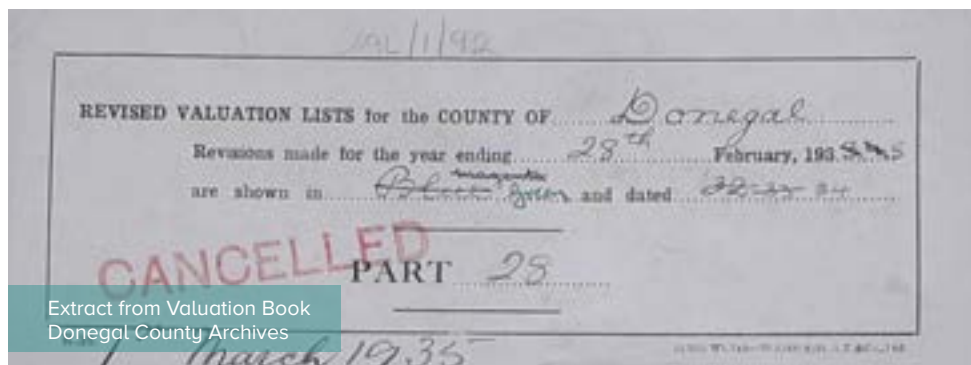

Extract from Valuation Book Donegal County Archives

Electoral (voters') registers, c.1880s – 1980s

The electoral system was reformed from 1898 to 1918, allowing more ordinary people to be included on the register. After 1898 women appear on registers as local government electors, as limited parliamentary electors after 1918 and as full electors after 1922. The survival rate for Co. Donegal's electoral registers varies considerably. **List of the registers held by date:**

1886: Polling district of Carndonagh

1889: Polling districts of Newtowncunningham and Kilmacrennan; Ballyshannon

1894 – 1895: Polling districts of Dungloe, Dunfanaghy, Lifford, Letterkenny, Stranorlar, Churchill; South Donegal; Killybegs; Pettigo

1898: Polling district of Ballintra

1902: Polling districts of Letterkenny; Altnapaste, Cloghan, Ardara, Fintown; Graffy and Polling districts of Glenleehin (Glenties), Maas, Arran, Dowras, Maghery, Rutland, Annagary, Croveighey, Doochary, Dungloe, Lettermacaward

1914: Buncrana district

Registration Unit of Elec. Parliamentary Polling District of Buncrana.

Household	Name of Occupier	Place of Birth	Age	Sex	Religion	Other
1	W. Conolly, Esq.	Chicago	40	M	Protestant	
2	W. Conolly, Esq.	Chicago	38	M	Protestant	
3	W. Conolly, Esq.	Chicago	36	M	Protestant	
4	W. Conolly, Esq.	Chicago	34	M	Protestant	
5	W. Conolly, Esq.	Chicago	32	M	Protestant	
6	W. Conolly, Esq.	Chicago	30	M	Protestant	
7	W. Conolly, Esq.	Chicago	28	M	Protestant	
8	W. Conolly, Esq.	Chicago	26	M	Protestant	
9	W. Conolly, Esq.	Chicago	24	M	Protestant	
10	W. Conolly, Esq.	Chicago	22	M	Protestant	
11	W. Conolly, Esq.	Chicago	20	M	Protestant	
12	W. Conolly, Esq.	Chicago	18	M	Protestant	
13	W. Conolly, Esq.	Chicago	16	M	Protestant	
14	W. Conolly, Esq.	Chicago	14	M	Protestant	
15	W. Conolly, Esq.	Chicago	12	M	Protestant	
16	W. Conolly, Esq.	Chicago	10	M	Protestant	
17	W. Conolly, Esq.	Chicago	8	M	Protestant	
18	W. Conolly, Esq.	Chicago	6	M	Protestant	
19	W. Conolly, Esq.	Chicago	4	M	Protestant	
20	W. Conolly, Esq.	Chicago	2	M	Protestant	

Electoral Register for Buncrana, 1914
Donegal County Archives

1919: Glenties Electoral Area (West Donegal)

1925 – 1926: South Donegal Electoral Area, Milford Electoral Area; Glenties Electoral Area

1929 – 1930: South Donegal Electoral Area; Milford Electoral Area; Glenties Electoral Area

1936 – 1937 and from **1963 – 1989:** Electoral Registers exist for all electoral areas. Registers over 30 years old are generally available to view. Some Electoral registers for the period 1938 – 1962 are held at the National Archives and National Library, Dublin.

Jurors Lists: Lists of those selected as jurors for the years 1913, 1921, 1923, 1929

These lists give significant information including name, residence; nature of qualification, e.g. 'rated occupied householder', title or business. There are lists for most electoral areas or districts though dates for surviving records vary.

Donegal Grand Jury records: 1753 – 1899



The last Donegal Grand Jury 1899
Donegal County Archives

Grand Juries existed in Ireland since Norman times. The Grand Jury in each county was made up of landowners, selected by the County Sheriff. Each Grand Jury was presided over by an Assize Judge and thus had no corporate existence. Assizes were held twice a year. Before the assizes, presentment sessions were called in each barony during which proposals for work to be done were considered and submitted to the Grand Jury for ratification. Services provided and paid for by Grand Jury Cess (a tax rate paid by occupiers) included making and repair of roads and bridges, construction of courthouses and levying for support of hospitals, schools and prisons.

Grand Juries' administrative functions were abolished in 1898 to make way for the modern democratic system of local government in existence today.

Records include:

Presentments of works to be done by contractors for the Assizes. These give names of contractors on projects such as road and bridge work; hospitals; prisons; schools; for services including translation from the Irish language and for providing for 'deserted children.'

Dates for surviving records: 1753 – 1769; 1768 – 1783; 1769 – 1778; 1793 – 1798; 1807 – 1808; 1809 – 1810; 1831; 1840; 1841; 1844; 1845; 1847; 1848; 1849; 1856; 1857; 1867; 1868; 1870; 1873; 1874; 1876; 1877, 1878, 1879, 1880, 1886, 1890,

1891, 1892, 1894, 1898.

Grand Jury Map of County Donegal, 1801
Minutes of meetings of Donegal Grand Jury: 1815 – 1857

List of Donegal Grand Jury members, 1835 – 1892

List of Grand Jury Cess/Tax Collectors, 1816 – 1892

Correspondence between last members of Donegal Grand Jury and newly elected members of Donegal County Council, 1898 – 1899

Photographs of the last Donegal Grand Jury, 1899

Poor Law Unions: Workhouses and Hospitals, 1840 - 1922

Under the Poor Law Act of 1838, Ireland was divided into Poor Law Unions or areas, each one run by a Board of Guardians. The principal responsibility of the boards was to supervise the running of the workhouses. There were eight workhouses in County Donegal, all built during the early 1840s - Ballyshannon, Donegal, Dunfanaghy, Glenties, Inishowen, Letterkenny, Milford and Stranorlar. The boards acquired other functions over the decades, including building and running fever hospitals, ensuring vaccination and managing dispensaries. The Workhouse system was abolished under the new Irish Free State in 1922.

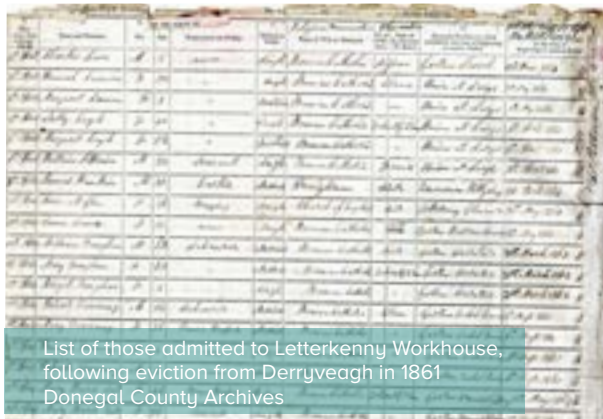

List of those admitted to Letterkenny Workhouse, following eviction from Derryveagh in 1861
Donegal County Archives

Records include:

Minutes of meetings of Boards of Guardians who managed the workhouses, 1840 – 1922. The minutes contain the decisions made on matters including collection of rates, maintenance of the building, workhouse and hospital staff, suppliers, disciplinary issues, public health etc. Names referred to include the Guardians themselves, the Master, Matron, nurses, school teachers, wardens, rate collectors etc. Contractors such as suppliers of bread, oats, materials etc. are also mentioned. In some instances workhouse inmates are discussed, usually in connection with a disciplinary or administrative matter. In some minute books specific inmates are referred to as having been placed on lists for emigration under specific government emigration schemes.

Admission & Discharge Registers and Indoor/Outdoor Relief Registers

These give name, age and address (townland), religion, occupation etc, of individuals seeking relief; if infirm or ill; date of admission and discharge or death.

The following admission or relief registers survive:

Ballyshannon (the workhouse admitted people from parts of Fermanagh as well as south Donegal): 1906 – 1924.
Donegal: 1914 – 1924.

Dunfanaghy: 1891 – 1915.

Glenties: 1850 – 1866; 1884 – 1895; 1899 – 1907; 1914 – 1921

Glenties Fever Hospital admissions, 1913 – 1921.

Inishowen: 1843 – 1859; 1899 – 1918.

Letterkenny: 1855 – 1878; 1864 – 1878; 1910 – 1922; dispensary register, 1843 – 1858.

Milford: 1847 – 1923; 1855 – 1897; 1919 – 1923.

Record of Deaths:

Milford: 1853 – 1893; 1899 – 1918.

Letterkenny: 1910 – 1922.

Punishment book:

Milford workhouse, 1879 – 1896.

Dispensary Registers:

Stranorlar and Killygordon, 1852 – 1899: giving names of staff, such as medical officers and midwives.

NOTE: *Strabane Workhouse includes records for part of east Donegal such as Lifford, Raphoe, St. Johnston, Convoy etc. Londonderry (Derry) Workhouse admitted people from Burt, Killea, Newtowncunningham and as far north as Fahan. (Strabane & Derry Workhouse records are held in the Public Record Office of Northern Ireland).*

Board of Health and Public Assistance, 1924 - 1942

The Board of Health & Public Assistance existed from 1924 to 1942. Following its dissolution, its functions were absorbed into the County Council.

Surviving records include bound volumes containing the minutes of meetings of the Board and its sub-committees. These detailed minutes include correspondence and reference to payments to medical professionals for various duties, including maternity services and dispensary attendance; and other staff matters. Other issues include unemployment assistance; management of district hospitals; management of the County Home in Stranorlar; labourers' cottages; boarding out (fostering) of children.

Other Committees established under the Board include on subjects such as infectious diseases; school medical and milk schemes; fire fighting; water supply; sewerage. There are monthly reports of officers including the County Medical Officer, District Nurses and TB Officer.

District Hospitals & Dispensaries

A relatively small number of items survive relating to district hospitals in County Donegal mainly dating from early to mid 20th century. Many of these contain names of staff who worked in the hospitals.

Records include:

Ballyshannon Medical Relief Registers, 1915 – 1943;
Medical Officer's Report Book, Ballyshannon Dispensary, 1899 – 1944;
Admission Register, Ballyshannon, 1924 – 1928;
Glenties Fever Hospital Committee Minute Book, 1922 – 1923;
Letterkenny Fever Hospital Register, 1924 – 1927;
Day Book, County Hospital, Lifford, 1924;
4 x Diet Books, County Hospital, Lifford, 1924 – 1928;
Accounts and Minutes, Ramelton Fever Hospital, 1891 – 1914;
Vaccination Register, 1926 – 1928.

Please note: *All health related records less than 100 years old are closed to the public but information can be extracted for family/ descendants.*

Donegal District Lunatic Asylum/ St Conal's Hospital, 1866 - 1958

Records include:

Case books for patients, 1896 – 1910.

Registers of Discharge and Death including 1866 – 1892.

Registers of patients from 1866 to 1933.

Register index books and reception order books for patients: 1896 – 1958.

Staff register 1909 – 1915.

Please note: *St Conal's patient records are closed to the public but information can be extracted for family/descendants.*



Gates of St Conal's Hospital, Letterkenny
Donegal County Museum Collection

Donegal Landed Estate Papers

c.1700 - 1950

Estate papers from various locations all over County Donegal include rentals and correspondence.

Alexander Murray Stewart - South West Donegal including Kilcar and Killybegs: rentals, leases, correspondence, c.1780–1900 (with gaps).

Edward Harvey - Ludden, Bunrana, Inishowen 1879: maps of estate with names, c1900.

Colonel Kennedy - Cashelnagor, upper Baltony (Beltany), Pound Town, (Cloughaneely Area): rental 1869.

John and Abraham Hamilton - Ballinamore and Fintown: rentals, 1818, 1849.

Montgomery and Boyton families- Convoy House, Convoy: a significant collection including correspondence, legal deeds, rentals, photographs and farm accounts for the Estate, c. 1780 – 1900.

Grove family - Castlegrove, Letterkenny: judicial rent register, farm account books, letters, 1870s – 1880s.

Richard and Jane Doherty - East Inishowen barony including Moville: notices to quit, 1866 – 1868.

Steele Nicholsons - Falmore House, Gleneely, Inishowen: rentals, legal deeds including leases, conveyances, newspapers, Wills, correspondence, diaries and photos, 1780s - 1890s.



Alexander Stewart of Ards, Dunfanaghy: agreement ledger between Stewart and tenants, 1856 – 1896 and Trustee Account of the will of Alexander Stewart (1873).

Captain Humfrey, Cavanacor House: rental, 1822 – 1835.

Lord Leitrim (Clements of Fanad): 19th century rentals and maps.

John Stoupe Charley- Arranmore, 1862 – 1885: rental.

Marquis Conyngham - Abstract of Title of Conyngham's estates: rental of estate in Stranorlar, 1887.

Minchin Lloyd - Crosconnell, Clonmany: rental and accounts of the estate of, 1798 – 1820.

Sir Arthur Chichester- Moville parish: rental of lands being sold, 1851.

Robert Sweeney - Ballyshannon & Bundoran: property rentals, 1915 -1918.

Henry Brooke – Letterkenny: bound volume of maps of estate for parts of Letterkenny and outskirts with lists of tenants, 1845 – 1850.

Stewarts, Hewetsons, Johnstones - Lough Veagh House, Gartan: Wills and Conveyance, mid-late 19th Century.

O'Donnell family Genealogy

These records, compiled by Rupert S. Ó Cochlain include:

- An illustrated scroll in Latin giving a detailed history of the O'Donnell clan(s) plus family tree with family crests.
- Register of correspondence between the Spanish members of the O'Donnell Family, Madrid and elsewhere in Spain and Irish O'Donnells, written in the 1870s.
- 'Pedigree' Book, with transcriptions from many books, articles and archives on various issues relating to the O'Donnell and other Gaelic clans.
- 'Poem Book' of the O'Donnells containing writings and poetry, prose and historical notations, mainly in the Irish language, mainly taken from Tomás Ó Cléirigh's 'A Poem Book of The O'Donnells'.
- Copies of various items relating to the genealogy of the O'Donnell clan and related families in Europe, including Austria and Spain.

Motor Tax Register, 1903 – 1923

Donegal County Council's first Register of Motorcars and Motorcycles in County Donegal.

Please Note: Motor tax registers from 1951 to 1992 are in the Archives collection.

While these cannot be generally viewed in the Archives, information requested can be extracted for researchers by Archive staff.



Joe O'Loughlin Collection
Donegal County Archives

Land Commission

In 1881 the Irish Land Commission was founded to establish fair rents. In 1885 the Ashbourne Land Act transformed the commission's main function from fixing rents to breaking up estates and facilitating tenant purchase of their holdings. Between c. 1885 and 1920 the commission oversaw the transfer of 13,500,000 acres.

- Court of The Land Commission, July 1883, December 1891, January 1892:
- Derry, Letterkenny and Stranorlar, Strabane (Co. Tyrone): lists of court hearings to be heard by Land Commission regarding lands and tenants.
- 1889: Stranorlar and Glenties, *ibid.*
1890: Glenties. Lists tenants' names, landlords, union, electoral division, post town, poor law valuation, rent and judicial rent.
- Land Commission Schedule of untenanted land held by Lady Ena Dingwall Tosca Stewart-Bam and Charles F. Stewart at Falcarragh and Kilmacrenan, 1924.
- Land Commission, court lists for Letterkenny and South Donegal, for land being sold c1900.

Nationally, there are no immediate plans to make the 8 million former Irish Land Commission (ILC) records

generally available to the public for research purposes or otherwise.

Legal Deeds and documents, c1750 – 1970

Legal Deeds from across the county including leases, probate documents, conveyances, letters of administration of estate, Wills, folios, settlements, Power of Attorneys, Abstracts of Title, Assignments, Assents, Schedule of documents, agreements, search documents, mortgages.

Please note: Some 20th century items are restricted due to privacy and data protection issues.

Petty Sessions 1828 - 1857

Petty Sessions records give names of those before the court in Civil and Criminal cases.

- Ballyshannon, 1828 – 1855
- Newtowncunningham, 1842 – 1857

Burial Registers/Maps c1938 - 1970

- Burial registers dating from 1938 to c1970
- St Johnston, Raymoghey (Manorcunningham), Milltown (Burt), Aughanshin, Killydonnell and Leck (Letterkenny), map of Killybegs graveyard.

National School Records c1850 - 1980



Newtowncunningham National School c.1900
Donegal County Archives

National (Primary) Schools roll books, registers and inspectors' report books for a large number of County Donegal primary schools, including those that are no longer in existence and those still in existence.

For a full and updated list of schools please see www.donegalcoco.ie/culture/archives

Rolls and registers over 100 years old are available in general to view; there is restricted viewing on items under 100 years old but information can be extracted for family members.

Lifford Prior School 1880 – 1971

- Roll book (1930 – 1959)
- Registers of pupils, 1921 – 1970
- Headmasters' reports, 1929 -1971
- Examination records, 1889 - 1971
- Attendance Report books and registers: include pupils' name and number on the register, class, cash received in stationary and in fees, observation on fees, number of attendances
- Record of punishment etc. 1880 – 1971 (with gaps)

Ray Charter School, Manorcunningham, 1794/1816

- Inspector's book, 1794
- Minutes of meetings of the school board, 1816, with references to the boys in the school.

Donegal Local Authorities, Minutes of meetings, 1896 -

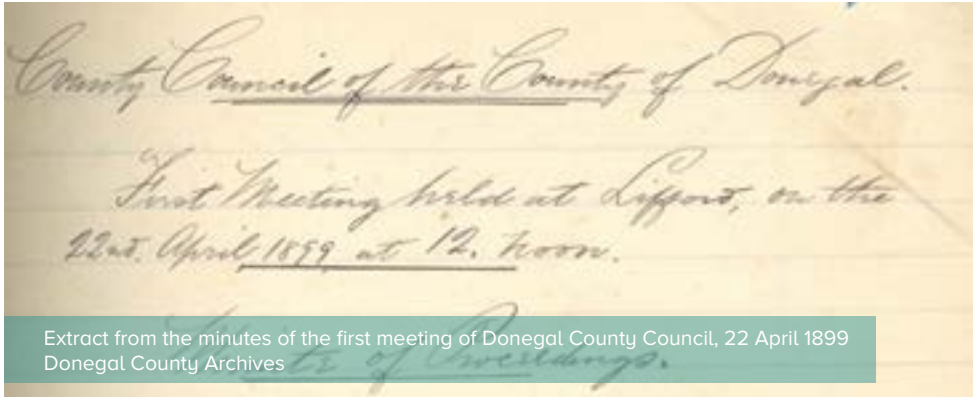

The records of Donegal Local Authorities, both extant and predecessor bodies include names of local authority members, staff and others. Records of significance include:

- Minutes of meetings of Donegal County Council from 1899.
- Staff and Council attendance registers.
- Minutes of meetings of Letterkenny, Buncrana and Bundoran Urban
- District Councils, 1899 – 2014.
- Minutes of meetings of the Rural District Councils of Ballyshannon, Donegal, Dunfanaghy, Glenties, Inishowen, Letterkenny, Londonderry No. 2, Milford, Strabane No.2, Stranorlar, 1899 – 1925.
- Ballyshannon Town Commissioners, minutes of meetings, 1896 – 1963.
- Letterkenny Town Commissioners, correspondence, 1880s – 1890s

Labourers' Cottages, c.1890 - 1950

Cottages were built for landless labourers by local authorities such as the Boards of Guardians, Donegal County Council and the Rural District Councils under late 19th century and subsequent legislation. Surviving documents relating to family history include registers of those housed, applications for housing; inspectors' reports, maps, plans; drawings; records relating to the administration of the various housing schemes (Some restrictions apply.)

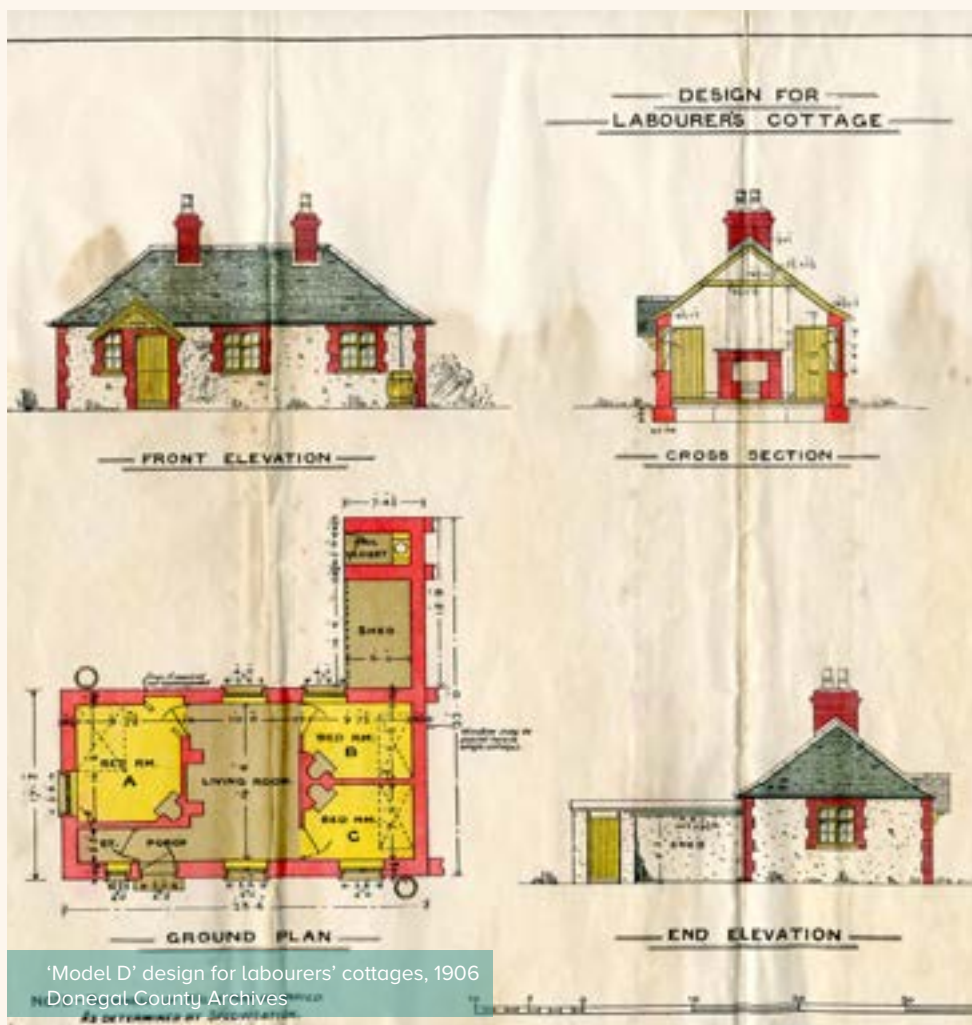

Significant Private Collections

Other collections in Donegal County Archives contain records which may be useful in tracing family history:

- **Donegal Board of the GAA** (Gaelic Athletic Association) includes minutes of meetings of the Board and committees as well as programmes, annual reports and correspondence.
- **The Gweedore and Lough Swilly Hotel** Visitors' books contain the names of the wealthy and often well known visitors to the county.
- **The Joseph Murray collection** (1920 – 1922) contains the names of people involved in the War of Independence with Murray.
- **The Fr. Patrick Gallagher and County Donegal Historical Society Collections** contain correspondence, articles, newspaper cuttings and photographs relating to the society and its members, as well as to County Donegal genealogy. Documents include on the O'Donnell clan, the Shiels and Sweeneys of Ballyshannon, the Montgomery estate in Convoy, Hugh Allingham, families of the Finn Valley; and many other records; c. 1940 – 1980.
- **Robert Moore, Clerk of Inishowen Union**, a Collection of papers regarding family and local business issues in Carndonagh and Buncrana.
- **Buncrana Shirt Factory** employee records from 1935 to 1979. Please Note:restricted access.
- **Daniel Doherty Collection.** Daniel Doherty emigrated from Malin Head to Boston. A collection of private papers, mainly relating to his longstanding membership of the Donegal Association of Boston, his lobbying on Irish reunification and political activities in Boston. Mainly dating from the 1950s to the 1970s.
- **District Nursing Associations** of Fanad, Newtowncunningham, Burt, Killea and Ballyshannon: including information on the employment of district nurses. 20th century.
- **County Committees of Agriculture** were set up by the British Department of Agriculture and Technical Instruction to administer agriculture related courses and general agricultural and rural economy support across Ireland. There is a significant collection of Co. Donegal Committee of Agriculture, including minutes of meetings and letters from the Dept. Included are lists of prizewinners, names of suppliers and those on the committee. 1909 – 1988.

Donegal County Museum



Donegal County Museum is located on High Road, Letterkenny, Co Donegal
T +353 (0)74 9124613
E museum@donegalcoco.ie

ADMISSION FREE

Opening Hours:

- 10am – 4.30pm Monday to Friday
- 12.30 – 1pm Closed for Lunch
- 1pm - 4.30pm Saturday
- Closed on Sundays and Public Holidays

About Donegal County Museum

Donegal County Museum is based in an old stone building, which was once part of the Letterkenny Workhouse, opened in 1845. The exhibition in the first floor gallery tells the story of County Donegal from Prehistory to the Twentieth century. In the ground floor gallery a series of temporary exhibitions are held throughout the year, which cover a wide range of topics. An event and education programme runs throughout the year on a wide variety of themes and topics.

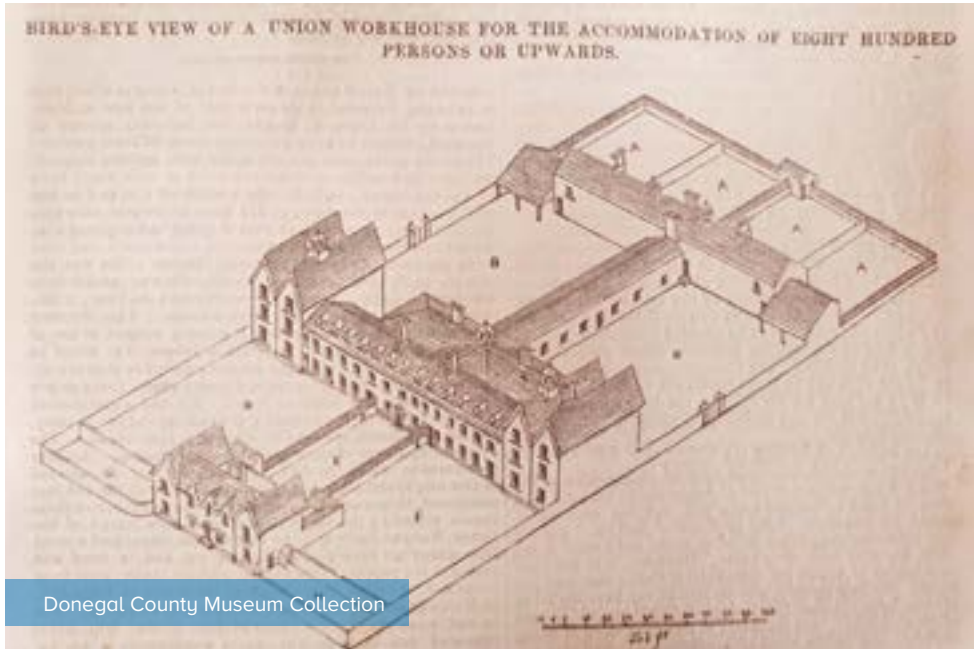

The role of Donegal County Museum is to collect, record, preserve, communicate and display for the use and enjoyment of the widest community possible, the material evidence and associated information of the history of County Donegal.

Donegal County Museum houses a substantial collection of artefacts relating to the history and heritage of County Donegal. This collection represents a wide range of periods and topics. It is a good representative collection of the county, containing many interesting objects some of which are of national and international importance.

While Donegal County Museum is happy to provide guidance and assistance, it is not a genealogical institution and in general we cannot conduct detailed research for individuals.



First Floor Gallery, Donegal County Museum
Photographer: Paul McGuckin

County Donegal Book of Honour

The Great War 1914-1918

Donegal County Museum has updated and reprinted a 5th Edition of the County Donegal Book of Honour: The Great War 1914-1918 which contains the names of all those from Donegal who died during World War I.

Donegal County Museum has been undertaking research on all those from Donegal involved in World War I since 2001. The Museum has previously organised exhibitions and a programme of events examining the story of Donegal's role in the War.

Donegal County Museum has carried out extensive research on those from County Donegal who took part in World War I. They would be happy to assist you with any queries relating to Donegal and World War I.

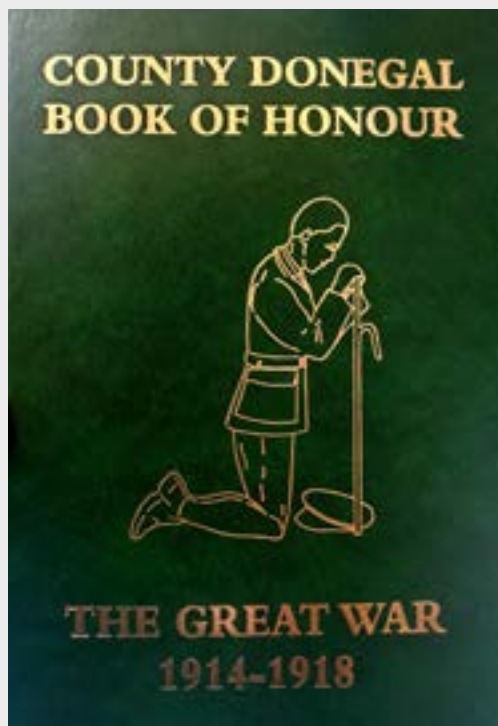

New information

If you have any additional information on the men and women listed in the County Donegal Book of Honour or have any additional names please send by **email** to: museum@donegalcoco.ie

or

post to:

County Donegal Book of Honour,
Donegal County Museum, High
Road, Letterkenny, Co Donegal

Useful websites include:

- The Commonwealth War Graves Commission (CWGC) honours the 1.7 million men and women of the Commonwealth forces who died in the First and Second World Wars. www.cwgc.org
- The British Army: The original records are all in the British National Archives in London. Their Medal Card records are very useful for World War I servicemen. www.nationalarchives.gov.uk/help-with-your-research/research-guides/british-army-medal-index-cards-1914-1920/
- Surviving service records of World War I are transcribed at www.ancestry.co.uk
- Pre-1914 service and pension records available on www.findmypast.co.uk
- Voluntary project to list all of Ireland's World War I veterans 1914-1918 www.worldwar1veterans.com
- Irelands Memorial Records for World War I imr.inflandersfields.be/search.html
- Australians and New Zealanders in World War I www.discoveringanzacs.naa.gov.au/
- Canadian personnel World War I records <https://www.bac-lac.gc.ca/eng/discover/military-heritage/first-world-war/Pages/introduction.aspx>
- American overseas military burial and memorial information www.abmc.gov/database-search



2nd Battalion Irish Guards, 1918
Donegal County Museum Collection

Film Archives in Donegal County Museum

North West Film Archive

This is a unique digital collection of film archive material on Derry and Donegal. It contains 90 hours of programmes, documentaries, feature films, shorts and news footage from some of the major television channels as well as Super 8 amateur film and home video dating back over 50 years. The archive is available for viewing free of charge without appointment (also available to view at Donegal County Archives.)



Donegal County Museum Collection

Gortahork, Co. Donegal



Arranmore
Donegal County Museum Collection

The Donegal Islands Film and Radio Archive

This is a unique digital collection of archive material relating to the islands of County Donegal. The archive provides free public access to nearly 40 hours of film, television and radio material through items such as newsreels, television and radio news and documentaries.

The audio and visual material contained in this archive will give an understanding of the social history of the offshore islands of County Donegal from the 1950s to the present day. The archive is available for viewing free of charge without appointment.



Boat leaving Bunbeg Harbour from Tory Island
Donegal County Museum Collection



Dunree, Co Donegal
Donegal County Museum Collection



Donegal woman spinning wool
Donegal County Museum Collection



Rutherford family, Falcarragh
Courtesy Caroline Carr



Donegal County Museum Collection

The Square, Lifford, Co Donegal 1935

Publications

The Museum has published a variety of booklets, which are available free of charge. **Please note:** *Some of these publication are only available as Pdf's.*

- “From Home to Foreign Fields”, A History of the First World War in the Derry City, Strabane District, Omagh District and Donegal County Council Areas
- A Guide To The Plantation Of Ulster in Derry And Donegal
- Plantation Architecture and Landscape In Derry And Donegal
- The Legacy Of The Plantation In Derry And Donegal
- The Ulster Covenant, 1912
- From Leaders to Exiles – related to the exhibition on the Flight of the Earls
- ‘A Vanished World ‘ – The Landed Gentry of Donegal
- ‘A Long Farewell’ – The Emigration of Donegal Women 1845 – 1950
- Donegal, the 1918 General Election and the First Dáil

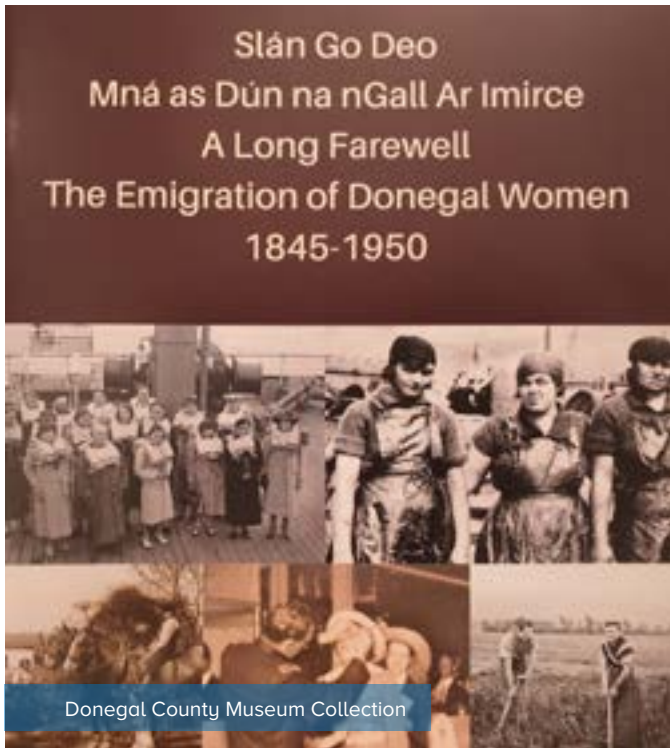

OTHER RESOURCES

The following are only a sample of websites which may be of use to you on your family history journey;

www.irishgenealogy.ie Indexes to deaths, births and marriages from 1864.

<http://www.donegalgenealogy.com/> Transcripts of thousands of Co Donegal family history records.

www.askaboutireland.ie/

www.familysearch.org

<https://www.nidirect.gov.uk/proni> Public Record Office of Northern Ireland: many County Donegal landed estate papers are held here.

www.findmypast.ie Most features of this website can be accessed without charge at Donegal's libraries and Archives. It includes registers and minute books from County Donegal's eight workhouses.

<http://www.rootsireland.ie/>

www.ancestry.co.uk

www.nli.ie National Library of Ireland holds many landed estate papers.

<http://registers.nli.ie/> Catholic parish registers online, free of charge.

www.irishmanuscripts.ie/product/the-civil-survey-a-d-1654-56-counties-of-donegal-londonderry-and-tyrone-vol-iii-with-the-returns-of-church-lands-for-the-three-counties-10-vols-1931-61/ The Civil Survey of 1654 lists owners and leaseholders of property.

<https://churcharchives.ie/raphoe-diocesan-archives> Raphoe Diocesan Archives

<http://www.genealogy.nationalarchives.ie/> & <http://www.census.nationalarchives.ie/> These websites include the Census 1901, 1911; Tithe Applotment Registers 1830s & Valuation records 1820s – 1840s.

www.gov.ie/en/campaigns/af7893-general-register-office/?referrer=/gro/ General Registry Office, Ireland.

www.qub.ie/cms/ A database of sources for emigration from Ireland to USA.

<https://www2.hse.ie/births-deaths-and-marriages/> HSE Civil Registration Service. It registers all births, deaths and marriages in Ireland.

www.nidirect.gov.uk/services/go-groni-online Certificates of births, marriages and deaths registered in Northern Ireland from 1922 onwards are available at the General Register Office for Northern Ireland in Belfast.

<http://www.irishgraveyards.ie/> Burial grounds transcripts of graves and photos of graves.

<http://www.prai.ie/> Registry of Property land in Ireland.

www.valoff.ie/en/archive-research/ Valuation Office records.

www.derry.rootsireland.ie Derry Family history records.

<http://soldierswills.nationalarchives.ie/search/sw/home.jsp> Soldiers' Wills from World War 1.

<https://irelandxo.com>

